

LEDBURY TOWN COUNCIL

ENVIRONMENT & LESIURES COMMITTEE	21 NOVEMBER 2019	AGENDA ITEM: 7
---	-------------------------	-----------------------

Report prepared by Angie Price – Town Clerk

REQUEST FROM RESIDENT IN RESPECT OF OVER-HANGING TREE

Purpose of Report

The purpose of this report is to make Members of the Environment & Leisure Committee aware of a request from a resident of Orchard Place in respect of a tree that overlooks his property.

Detailed Information

At a meeting of the Environment & Leisure Committee in October 2018 consideration was given to a report which had been commissioned by Ledbury Town Council into a number of trees at Orchard Place, Ledbury, following an enquiry from a resident in respect of Tree No. 29 (a copy of the report is attached for information).

The report advises that Tree No. 29, a Beech Tree, is in good condition, but that there is multi-stem presence due to the absence of formative pruning.

The committee considered the report and it was resolved at Minute No. E95-10.18 that a recommendation be made to Full Council to proceed with the work as outlined in the report, and that a copy of the report be sent to the owner of T8 as a matter of courtesy. The minutes of the meeting of this meeting were considered at the meeting of Full Council held on 1 November 2018, and whilst the minutes and all recommendations therein were approved, there was no specific mention of minute no. E95.

Following the meeting of Full Council, former Councillor Hopkins wrote to the residents advising of the outcome of the report, noting that the tree in question had been deemed in a good condition, with no works required at that time, but that the Council would review the trees in the area annually and enclosing a copy of the report.

It is worth noting at this stage that minute of the Environment & Leisure Committee referred resolved that "a copy of the report be sent to the owner of T8 as a matter of courtesy", but that the tree referred to by the resident was T29.

In September 2019 Councillor Whattler was approached by the same resident in respect of T29, in so far as he felt the tree to be an issue due to its height and width. The resident has provided pictures of the offending tree and states that he believes the tree has grown considerably since last inspected and that he is very concerned that should the tree fall it could potentially damage his property. He particularly highlighted the issue in respect of the multi-stem element of the tree as it would appear the area to the base of the tree is "blackening" which he believes is a sign of the tree dying.

A sum of £1,500 was placed in a budget for the amenity areas in respect of "general tree works", £280 of this has been spent, which leaves a total of £1,220 in the budget, which should be more than sufficient to undertake a survey of the trees in this area, as suggested in the letter to the resident, dated 5 November 2018. The Clerk has written to three Tree Consultancy companies asking them to quote for the provision of a report on the trees at Orchard Place with a deadline for quotes of Friday, 29 November 2019.

Recommendation

That Members receive and note the above report and authorise the Clerk, in conjunction with the Chair of the Committee, to consider the quotes once received, and subject to the cost of the survey being within the budget of £1,220, appoint one of the companies to carry out the survey of the trees at Orchard Place.



LEDBURY TOWN COUNCIL

TOWN COUNCIL OFFICES . CHURCH STREET . LEDBURY
HEREFORDSHIRE HR8 1DH . Tel. (01531) 632306 . Fax (01531) 631193
e-mail: admin@ledburytowncouncil.gov.uk website: www.ledburytowncouncil.gov.uk

Your Ref:

Our Ref:

5th November 2018

Dear Mr and Mrs Coulson,

Re: Deer Park Trees.

As we have discussed, the council has commissioned a report into all the trees behind your property and I enclose a copy for your information.

As you can see the condition of the tree is described as good and no work is recommended for this tree at the moment,.

We will now be keeping the trees under annual review and following the recommendations contained the reports.

Best wishes,

 Cllr Jane Hopkins
Chair of the Environment and Leisure Committee
Ledbury Town Council

Encl: Tree Report

T. 2 9

141

B. J. UNWIN FORESTRY CONSULTANCY

Principal:

Jim Unwin BScFor, MICFor, RCarborA, FArborA, CEnv.
Chartered Forester - Arboricultural Association
Registered Consultant - Fellow of the Arboricultural Association -
Chartered Environmentalist.



Parsonage Farm
Longdon
Tewkesbury, Glos.
GL20 6BD, UK
T & F 01684 833538
M 07860 376527
Email Jim@bjunwin.co.uk



22nd Sept 2018 - BJU/mmi

Ledbury Town Council

Tracey Smith, Clerical Officer,

Tel: 01531 632306

e:mail: admin@ledburytowncouncil.gov.uk

Town Council Offices, Church Street, Ledbury, Herefordshire. HR8 1DH.

Dear Tracey,

Tree inspection @ Orchard Place, Ledbury, HR8 2XD.

1. Instruction.

- 1.1 Ledbury Town Council is concerned to safely manage the trees on various sites it owns.
- 1.2 Therefore, The Council has asked B.J. Unwin Forestry Consultancy to inspect trees and advise, by email of 20th Sept 2018. We had previously inspected some sites in 2011 & 2013.

2. Inspection.

- 2.1 We visited Orchard Place on 21st September 2018, and made an un-accompanied inspection in bright weather conditions.
- 2.2 The survey was from ground level. It involved visual observation, estimating dimensions, and sounding with a hammer; and chisel and long steel rod if required (Visual Tree Assessment: Mattheck and Breloer 1994 and Lonsdale 1999).
- 2.3 The survey was by Jim Unwin, who has forty years' experience working with trees, (professional CV attached), assisted by Phillipa Hunt.

Notes:

Copyright: This report is copyright of BJUFC, and licensed only to the client, site and purpose(s) named above. It may not be assigned without the author's permission.

Limitation of Report: The statements made in this Report do not take account of the effects of extremes of climate, vandalism or accident, whether physical, chemical or fire. BJUFC cannot therefore accept any liability in connection with these factors, nor where prescribed work is not carried out in a correct and professional manner in accordance with current good practice. The authority of this Report ceases at any stated time limit within it, or if none stated after two years from the date of the survey or when any site conditions change, or pruning or other works unspecified in the Report are carried out to, or affecting, the Subject Tree(s), whichever is the sooner.

Tree and Woodland Consultancy
Woodland Valuation and Timber Sales
Landscape Management

Visit our website: www.bjunwin.co.uk for more information



3. The Site.

- 3.1 The site inspected is dagger-shaped, and mostly mown grass. About 111m long by 43m maximum width. The centre of the upper lawned area contains large drainage inspection covers
- 3.2 The site is flat with a slight fall to the south west.
Solid geology from BGS website: Raglan Mudstone Formation - Siltstone and mudstone, interbedded. Sedimentary bedrock formed between 423.6 and 419.2 million years ago during the Silurian period.
Superficial deposits: No superficial deposits recorded.
Therefore we would expect subsoil to be fine-textured.
- 3.4 2013 Google Earth below. Mabel's Furlong path (well used) bounds the western side. Domestic plots bound other sides.



4. Trees.

- 4.1 The site was well-planted when adjacent houses were built, maybe 40-50 years ago? Some trees are good, such as Norway maple T30 and beech T29 in photo below. Horse chestnut T24 on right.



- 4.2 A few trees are beginning to out-grow their location, such as balsam poplar, centre in photo below.



- 4.3 Another tree becoming too dominant is Leyland cypress T22, right.
Note broken branches.

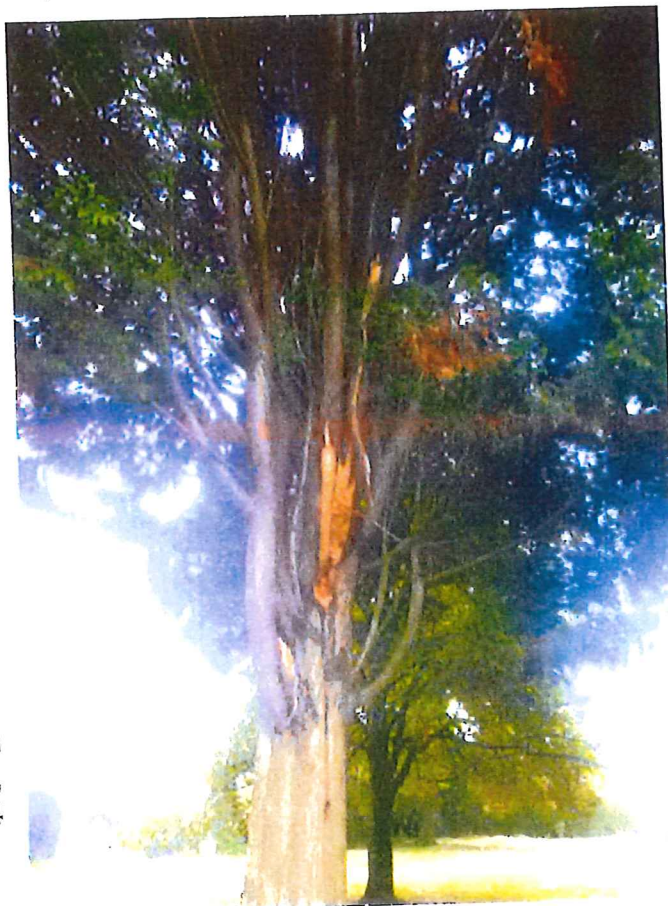

- 4.4 Photo below, looking north along Mabel's Furlong path, shows large ash crown T34 over path and adjacent house.



- 4.5 Overall, we would recommend some felling soon, followed by replanting to give a greater age range.

4.6 Tree schedule.

Overleaf is a schedule of trees.

Age class is described as:-

- Sap: Very young tree, or sapling, one-five years old.
- Y: Young tree less than fifteen years old and <1/3 fully grown.
- Sm: Semi-mature tree having attained 1/3 to 2/3 full stature and 1/3 to 1/2 estimated lifespan.
- Em: Early mature: tree at 2/3 to virtually full size, and halfway through its safe life.
- M: Mature: fully-grown tree with useful life expectancy.
- Lm: Late-mature: fully grown, of declining vigour, but still healthy.
- Om: Over-mature tree: fully grown and starting to decline in health (but may still have many years of safe life).
- Vet: Veteran: usually very old; of significant historic, habitat or cultural value.

SULE: Safe useful life-expectancy in years.

Recommended work + Priority:-

0.1-0.11 = months, 1 = one year, 2 = 2-3yrs.
S = Safety work - M = Management.

4.7 Sketch plan

Tree locations are given on the SKETCH Tree Plan, attached.

4.8 Orchard Place – Tree Inspection - BJUFC – 21st September 2018

No. T=tree S=shrub H=hedge G=group	Species	Old Dbh (stem diam @ 1.5m ht) mm.	Est. height.	Avg. crown radii	Age class	Health	Structural Condition	SULE	Comment (All are in average to good health and condition, unless stated otherwise.)	Recommended WORK excluding development.	Priority Year Safety or Management
T1	Almond	270	5	5 S	M	P	P	5	<i>Ganoderma</i> fungi fruit body at base.		
T2	Flowering cherry	250	5	4.5	M	P/ F	F	10- 20			
T3	Flowering cherry	300	5	5 E	M	P/ F	F	10- 20			
T4	Flowering cherry	310	5.5	4	Em	F	F	20- 40			
T5	Juniper	100	3	1.25	M	F	F	20+	Dwarf conifer.		

T6	Variegated holly	90, 130	5	1.5	Em	F	F	40+	Off-site?		
T7	Purple Norway maple	280	9	4 S	Sm	F	P	40+	Off-site? Pollarded at ½ height, creating decayed pockets.		
T8	Field maple	470	14	6 W	M	F	F	20-40	Good.		
T9	Ash	370	17	5 E	Em	F	F	20-40			
T10	Hawthorn	200 basal	5	2	M	P/ F	F	20+	Small.		
T11	Ash	450	18	6	Em	F	F	20-40	Tall and good.		
T12	Ash	280	18	4	Em	F	F	20-40			
T13	Ash	290	13	4 E	Em	F	P	<5	Very suppressed.	Recommend felling soon.	2m

T14	Silver birch	190	9	3	E	Sm	F	F	20+			
T15	Copper beech	490	18	5		Em	F	P/ F	40+	Several narrow weak forks, but intertwined stems provide natural bracing.		
T16	Rowan	150	5	1.5		Sm	F	F	20+	Small. Broken top.		
T17	Silver birch	300	15	5	E	Em	F	F	20+			
T18	Wild cherry	300	12	4	N	Em	F	P	<5	Suppressed.	Fell soon.	2m
T19	Balsam poplar	700	20	8	N	M	F	F	10-20	Big. May be outgrowing location. Ivy on stem.	Remove ring of ivy from ground level up to head height.	0.3m
H20 A, B, C	Hazel, hawthorn, and elder	150	3	1.5		Lm	P/ F	P/ F		Very overgrown hedge. Ivy.	God habitat. Coppice ALL elders. Repeat every three-five years. Trim hedge as required.	1m
T21	Horse chestnut	400	10	5	N	Em	P/ F	P/ F	10-20	Bacterial canker. Scruffy.		

T22	Leyland cypress	650	20	6	M	F	F	<10	Big. Some branches ripped off. Dominates bungalow to east.	Consider felling within five years.	5m/s
T23	Wild cherry	510	12	6	M	F	F	20+			
T24	Horse chestnut	400	11	5	Sm	F	F	>40			
T25	Sweet chestnut	150, 200, 250	9	6 N & S	Sm	F	F	20+	Coppice regrowth.		
S26	Viburnum lantana				M				Shrubby.		
T27	Flowering cherry	420 basal	4.5	6 W	M	F	F	20+	Low Japanese cherry.		
S28	Forsythia				M				Shrub.		
T29	Beech	700 basal	150	6	Em	F	F	>40	Multi-stem due to absence of formative pruning. Good.		

150

X

T30	Norway maple	520	15	6	Em	F	F	>40	Good.		
S31	Lilac				M				Off-site shrub.		
S32	Cherry laurel				M				Low shrub.	Coppice every five years.	2m
H33	Leyland cypress	100	2	0.6	Em	F	F	20+	Trimmed boundary hedges.	Trimmed by neighbours?	
T34	Ash	500, 500	19	6	Em / M	F	F	10-20	Self-sown in hedge. Pushing sycamore to south. Big. Growing over No.31 Bramley Close.		
T35	Sycamore	600	18	8 E	Em / M	F	F	>40			
T36	Hawthorn	260	6	3	Lm	P	P	20	Ivy smothered, in hedge.	Remove ring of ivy from ground level up to head height.	0.3m

End of table.

4.7 Treework informatives

4.7.1 Disturbance to wildlife.

It is essential to check for nesting birds, bat roosts, badgers and hibernating animals such as hedgehogs under trees, before pruning or removing trees, as negligent disturbance is an offence under the EC Habitat Directive 1992 as amended and strengthened 21st August 2007 to protect European Protected Species (bats are most relevant concerning trees) and CROW Act 2000.

In general, autumn tree work: **September, October and November** is least disruptive to bats and birds. However, with appropriate risk assessment work can proceed at any time.

4.7.2 Permission.

Trees may be protected by a TPO, or lie within a Conservation Area. Either are possible here and should be checked with the local planning authority.

A Felling Licence may be required for felling or thinning > 5 tonnes of wood in any calendar quarter.

As part of a felling licence, European Protected Species must be considered.

Therefore, a contractor must satisfy himself that all necessary permissions are in place before touching trees.

4.7.3 Contractor.

All off-ground tree work should be done by insured tree surgeon with certificates in aerial chainsaw use (new designations:- NPTC 020-04, 0020-05, 0020-07, 0021-01, 0021-07; LANTRA 600/5703/8, 600/5717/8, 600/5715/5, 600/5704/X, 600/5714/2), and working to BS3998:2010, and "Treework at Height", the Arboricultural Association's ICoP.

(Stumps can be left to shoot again, ground out, or grubbed out, or poisoned depending on location.)

Thinning work can be done by a competent woodland contractor.

5.0 Re-inspection:-

- 5.1 We would recommend a regular** walk-over inspection of the site, by a competent person: Groundsman, landscape gardener or tree surgeon. This should be recorded.

** Either annually (easy to diarise). Or if done at 15-month intervals, trees would be seen at different times of the year.

- 5.2 We would recommend an arboriculturalist inspection every five years, unless gross changes (e.g. dieback) raised concerns.

This report may be submitted to Hereford Council for permission if needed, and to contractors for quotes.

Please contact us if you have any queries, or require further assistance.

Yours sincerely,



B J Unwin Forestry Consultancy.

References:

"The Body Language of Trees". Claus Mattheck and Helge Breloer. HMSO 1994.

"Principles of Tree Hazard Assessment and Management". David Lonsdale. HMSO 1999.

BS 3998: 2010 "British Standard Recommendations for Treework".

Attached:

- Tree plan.
- BJUFC professional CV.

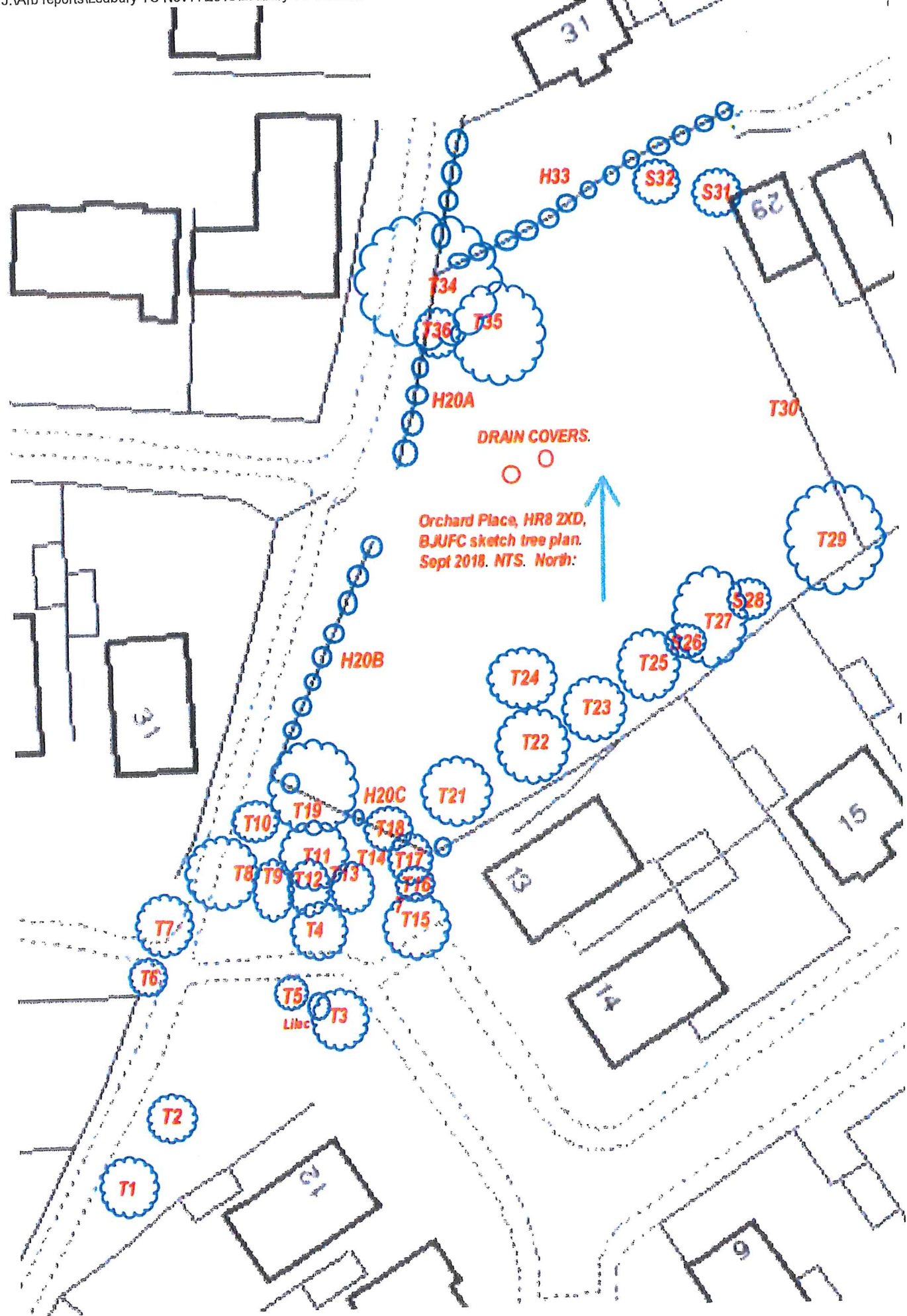

- B J UNWIN FORESTRY CONSULTANCY -

Head office: **Parsonage Farm, Longdon, Tewkesbury, Gloucestershire. GL20 6BD.**

Tel / Fax: 01684 833538. Home Tel: 01684 833795. Mob: 07860376527. E-mail: Jim@bjunwin.co.uk

Satellite Offices: - Haley Ridge, Highcliffe, Nr. Wadebridge, Cornwall, PL27 6TN.

-105 Charfield Court, 2 Shirland Road, London, W9 2JR.

Associate office: - 1 Market Place Mews, Henley-on-Thames, Oxfordshire, RG9 2AH.

Principal: **Jim Unwin BScFor, MICFor, FArborA, RCarborA, CEnv.**

Chartered Forester - ICF Registered Consultant - Fellow of the Arboricultural Association -

Arboricultural Association Registered Consultant - Chartered Environmentalist.

From:	Jim Unwin	To:	Prospective Client
Date:	Sept 2018	No. of pages:	2
Subject:	Professional CV		

Below are set out **B J Unwin Forestry Consultancy's** competences and experience.

Insurance:-

£5m Public Liability & £2m Professional Indemnity (renewed June).

Personnel:-

B J Unwin (born 1956) started his forestry career as a tree surgeon and landscape contractor in 1975. He studied forestry at Aberdeen University from 1977 to 1981, worked for Unilever as a Forestry Manager in the Solomon Islands from 1981 to 1983. Since then he has been based in Gloucestershire assisting clients to manage their woodland, trees and vegetation throughout Southern Britain, and occasionally in northern England, Scotland and Northern Ireland.

In the mid-1980s to mid-1990s for a period of about ten years he taught chainsaw, tree felling and tree surgery courses at Worcestershire Agricultural College on a part-time basis. He was assessed and passed as a LANTRA assessor in these skills, and held NPTC certificates of competence in chainsaw use on the ground and up trees.

He now works as a tree consultant / manager / contract manager to a range of clients listed below.

For tree decay testing we have a **PICUS II ULTRASOUND** tomograph with electronic callipers and **RESISTOGRAPH-R400** drill.

He works with two self-employed arboriculturalists of >20 years' combined experience:-

Jasper Fulford-Dobson Arboricultural Association Registered Consultant - Associate Member of the Institute of Chartered Foresters - Professional member of the International Society of Arboriculture - Technicians Certificate (ArborA) 2005, now regarded as NQF "level 4" - Professional Tree Inspection Certificate (LANTRA) 2013,

Owen Hutchison BSc(Hons) Agriculture & Estate Management, Level 4 Diploma Arboriculture, LANTRA Professional Tree Inspection & working with trees since 2007, & **Alex Collier** who in June 2016 achieved Pershore College Level 3 Extended Diploma in Forestry and Arboriculture, completing the course with a Distinction grade (+SC30). In July 2018 she attained Level 5 Arboriculture Foundation Degree with a Distinction.

Plus a secretary/ plan technician; calling in extra help as required (eg ecologist or arboricultural assistant). On bigger projects he regularly works as a part of a multi-disciplinary team.

Current BJUFC qualifications are:-

BSc Forestry Hons 1st Class, Aberdeen 1981.

Chartered Forester No. 0330064, 1986.

Fellow of the Arboricultural Association, 1995.

Licensed Subsidence Risk Assessor, 1997-2001 (scheme closed in 2001).

Completed Training in September 2002 to Prepare Native Woodland Plans for CCW and FC in Wales.

Arboricultural Association Registered Consultant No. 42, 2004.

LANTRA certificate for Arboriculture and Bats, BJU in 2005.

Examined and approved to submit Welsh WGS as Management Planner and PAWS Assessor, 2006.

Joined Utilities Vendor DataBase, Supplier No: 88101 in Feb 2006 (left 2010).

Training and Certification in basic CAD operation 2006.

Chartered Environmentalist April 2008.

Woodfuel Production and Supply : LANTRA Certificate of Training Dec 2008.

Training in CAVAT amenity tree asset valuation October 2010.

Company Safety Policy:- We have been successfully assessed by Safety Management Advisory Services (SMAS) as meeting CDM Regs 2015 Core Criteria Stage 1, as a **Worksafe Consultant No. 75950**, expiry 07/09/2019.
CITB Health, Safety & Environment Test for Managers & Professionals passed 22/01/2015.
First-aid at work June 2013.

Current clients and typical work include:-

English Heritage	Tree safety inspection contract 2007-2013 for East Midlands, East Anglia, London and SE England. Tree safety inspection contract for West of England & Midlands 2013-2019.
Planning Inspectorate (PINS) & Dept for Communities and Local Government. 2000-2017.	Arboricultural Inspecting Officer in South-West England, South East England, West Midlands and East Midlands; advising the First Secretary of State on TPO appeals since 2000. Contract with DCLG expired April 2008 when transferred to PINS. Contract continued with PINS, as Non-Salaried Arboricultural Inspector, determining TPO appeals and High Hedge appeals. All non-salaried inspectors released in 2017.
Architects / Developers / Planning Appeals	Complete Tree Constraints, Impact Assessment & Tree Protection advice for planning, working with other professionals to input arboriculture into more complex development schemes. Recent assignments in Liverpool to Dorset, Kent, Norfolk & London. All using BS5837:2012. FULL CAD CAPABILITY.
Amey Mouchel Ltd	Overseeing Amey Tree Officer on motorway and trunkroad tree inspections throughout Midlands and Marches to 2012. Amey Mouchel are agents for Highways Agency.
CRH Tarmac Ltd, + Midland Quarry Products + Quarryplan (in Northern Ireland).	Since 1990 working with Estates staff, quarry managers and Landscape / ecological consultancies organising and managing contracts for tree and woodland planting both pre- and post- quarrying. Also preparing landscape restoration schemes for straightforward sites plus landscape management on sites throughout southern England, East Anglia and south and south-west Wales. (Commendations for Land Restoration and Environmental improvements from Spelthorne Borough Council 2003.) Also in England & Northern Ireland ongoing tree consultancy for Quarryplan.
Bruton Knowles	Assisting BK clients with woodland management and other tree issues since 1984.
Tarmac Central now CRH Tarmac Ltd.	Since 1988 woodland management of Hopwas Hays Wood, Tamworth.
Rural estates in Herefordshire, Worcestershire and Gloucestershire, plus private woodland owners in southern England and Wales.	Since 1983 woodland management, tree management, hedgerow management. Many are Ancient woodlands and SSSI's requiring detailed ecological management plans produced in consultation with ecologists. About forty Farm Woodland Premium Schemes and about twenty Native Woodland Plans prepared to date in England and Wales. On-going EWGS grant applications. Input into Tir Gofal (and its successor) and Stewardship schemes. Better Woods for Wales (BWVW) applications.
British Waterways	Ten-year Tree and Vegetation Management Plans along canals and around reservoirs in London, Hertfordshire, Berkshire, Birmingham, Staffordshire, Worcestershire, Gloucestershire, Shropshire, Llangollen Canal, etc: plus help in dispute with riparian owners. This work ceased around 2011.
Stroud District Council	Management of 49Ha woodland since 1989 on FC schemes plus grassland on DEFRA Stewardship Schemes, including HLS. Retired Nov07.
One-off clients	Since 1983 assisting tree owners, developers, lawyers etc throughout southern or midland Britain, including Wales, on a wide range of tree-related issues including planning, planning appeals, subsidence, health & safety, disputes, vegetation control, expert witness, valuation of woodlands, standing and felled timber, Christmas trees etc, and tree and landscape planting schemes. Recently High Hedge issues and BS5837 are hot topics.
Malvern Hills District Council. South Oxfordshire District Council	BJU Stand-in part-time Consultant Tree Officer Summer 2003. JF-D stand in Consultant Tree Officer summer 2009 to spring 2010.
Golf course & leisure facilities	Assistance with development of Carden Park golf course in Cheshire. Management advice for trees on other golf courses: Eg Ross Golf Club, Swindon Golf Club.
Farm management	Management of own 95Ha farmland since 1985.

Please do not hesitate to ask for further information. B J Unwin END.

LEDBURY TOWN COUNCIL

ENVIRONMENT & LEISURE COMMITTEE	21 NOVEMBER 2019	AGENDA ITEM: 8
------------------------------------	------------------	----------------

Report prepared by Angie Price – Town Clerk

CONSIDERATION OF RE-FORMING GREEN SPACES WORKING PARTY

Purpose of Report

The purpose of this report is to ask Members of the Environment & Leisure Committee to give consideration to re-forming the Green Spaces Working Party to provide an avenue for discussion about green spaces in the town and how they can be improved.

Detailed Information

On 8 September Councillor Harvey responded to an email she had received in relation to tree planting in Ledbury, copying the Clerk into her response. In her email she advised that a resident had been in touch to enquire about having permission to carry out some works to the trees along the Riverside Park and also another resident who had offered some free consultancy work with regards the work needed alongside the Riverside Park and possibly also along the Town Trail.

Councillor Harvey advised, in her email, that the Town Council used to have a Green Spaces Working Party which met quarterly to discuss such issues and that there had been representatives from various organisations such as Ledbury in Bloom, Ledbury Naturalists, PACT, Community clean-up and more attending.

Councillor Harvey copied the Clerk into the email and as a result the Clerk would ask the Environment & Leisure Committee to give consideration to the suggestion that the Green Spaces Working Party be reformed.

Recommendation

1. That consideration be given to the reforming of the Green Spaces Working Party.
2. That should Members agree to the reforming of the Green Spaces Working Party the Committee nominate Members to sit on the Working Party.
3. That should Members agree to the reforming of the Green Spaces Working Party the Clerk be asked to arrange a meeting and that those listed above and any others that the Committee feel would be useful members of such a committee be invited.